

INSTALLATION INSTRUCTIONS

1. Attach trailer to tow vehicle. Use vehicle's parking brake and chock wheels of trailer.
2. The Powered A-Frame Jack has been designed to attach to the top surface of the A-frame coupler.
3. Disconnect the trailer battery ground cable.
4. Detach the drop leg of the jack by removing the lynch pin.
5. Position the drop leg beneath the coupler mounting hole with the foot of the drop leg on the ground.
6. Place the jack outer tube through the A-frame coupler hole and over the drop leg. The dual mounting pattern allows positioning of the jack either facing the tow vehicle or for side operation.
7. If the Plunger Pin kit is included with this jack, install per instructions below, then continue on to #8.
8. Attach the jack using the three (3) 3/8" diameter, 1" long, grade 5 bolts and nuts (provided). Use the provided lock washers, placing them between the bolt head and the top of the jack mounting bracket. Star washers are used to insure a metal-to-metal contact between jack and coupler for proper grounding (Figure 1). Torque bolts to 15–20 ft-lbs.
9. Route the black wire lead from the plastic cover along the trailer to the battery. Attach the wire lead to the trailer using cable ties or equivalent.
10. Connect the wire lead from the jack directly to the positive (+) terminal of the battery. This unit has a built-in circuit breaker which automatically trips and resets. Reconnect the battery ground cable.
11. Check for proper installation by pressing the motor switch that is marked "EXT" for extending the jack and "RET" for retracting the jack. Also check that the light switch turns on the LED light located under the top cover of the jack.
12. After checking for proper operation, be sure to reattach the drop leg to the inner tube of the jack using the lynch pin or plunger pin assembly.
13. Retract the jack completely.

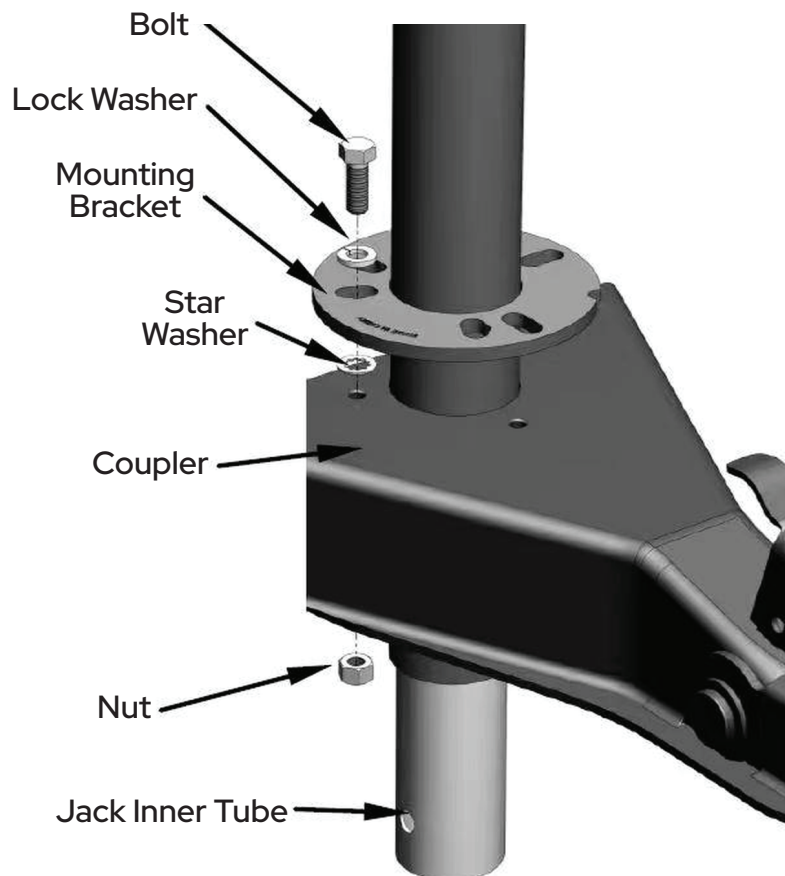

Figure 1